

A PORTION OF SECTION 32, TOWNSHIP 25 NORTH, RANGE 06 EAST W.M.

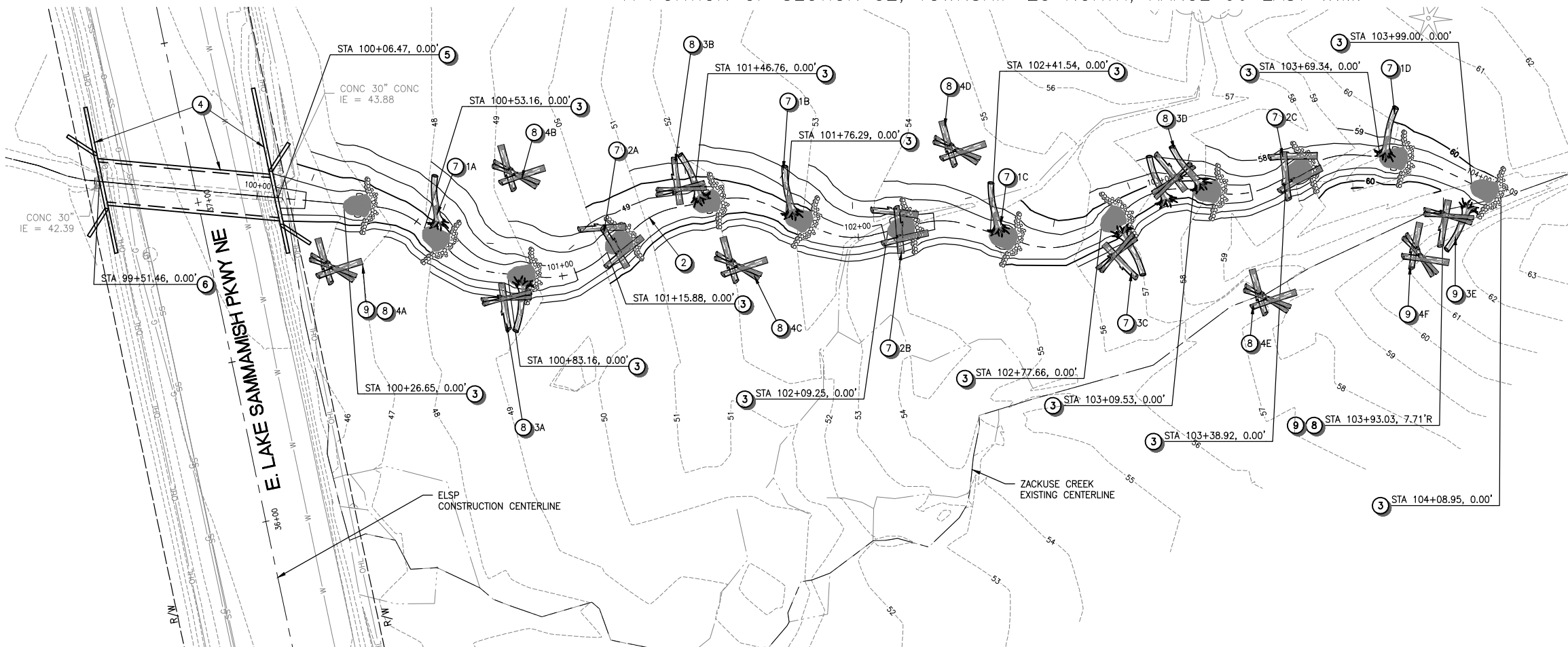

**CONSTRUCTION NOTES**

- 1 TIE IN TO EXISTING ZACKUSE CREEK CENTERLINE.
- 2 CONSTRUCT PROPOSED STREAM CHANNEL PER PROFILE ON THIS SHEET AND TYPICAL BEDFORM AND CROSS-SECTION DETAIL ON SHEET SR03.
- 3 CONSTRUCT TYPICAL STREAM BEDFORM STEP AND POOL PER DETAILS ON SHEET SR05. SEE SHEET SR03 FOR CONTROL POINT LOCATION.
- 4 INSTALL CULVERT AND WING WALLS PER DETAILS ON SHEETS ST01-ST06.
- 5 TIE IN UPSTREAM END OF PROPOSED CULVERT TO STREAM CHANNEL PER DETAILS ON SHEETS ST01-ST04.
- 6 TIE IN DOWNSTREAM END OF PROPOSED CULVERT TO KING COUNTY FINISH GRADE. SEE SHEET ST01 FOR ELSP CULVERT PROFILE AND SHEETS KC-XX TO KC-XX FOR DOWNSTREAM GRADING PLANS.
- 7 CONSTRUCT BANK WOOD STRUCTURE PER DETAILS ON SHEET SR04.
- 8 CONSTRUCT BANK WOOD STRUCTURE PER DETAILS ON SHEET SR05.
- 9 INSTALL DIVERSION LOG STRUCTURES ONCE STREAM IS ESTABLISHED IN CONSTRUCTED CHANNEL.

**LEGEND**

- STEP POOL
- LARGE WOOD STRUCTURE - SEE NOTE FOR TYPE

**GENERAL NOTES**

- 1 LOG STRUCTURES SHOWN IN PLAN VIEW ARE APPROXIMATE REPRESENTATIONS OF DETAIL TYPE. REFER TO SHEETS SR04-SR05 FOR DETAILS AND SECTIONS FOR EACH TYPE.

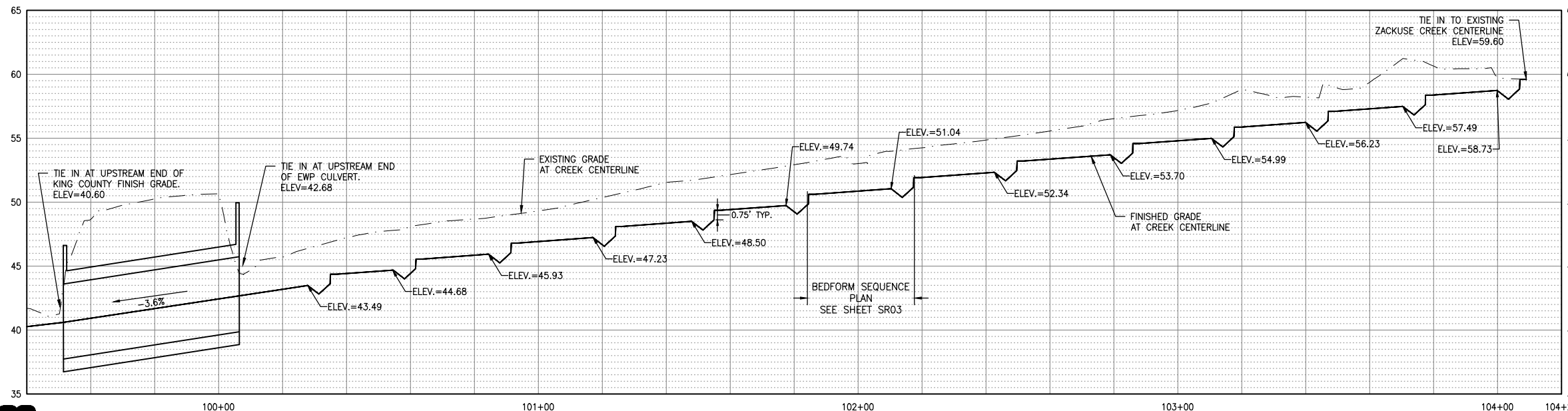

**ZACKUSE CREEK PROFILE**



ZACKUSE CREEK  
FISH WINDOW  
JULY 1 - SEPT 30

Know what's below.  
Call before you dig.

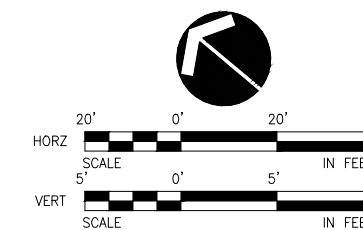

PRELIMINARY - NOT FOR CONSTRUCTION

ZACKUSE CREEK FISH PASSAGE AND STREAM RESTORATION PROJECT SAMMAMISH, WASHINGTON	NO.	REVISIONS	DATE	DATE: XX/XXX		STREAM CHANNEL GRADING PLAN AND PROFILE	SR01	
	1			DESIGNED BY:			SHEET	OF
	2			DRAWN BY:			18	31
	3			REVIEWED BY:				
	4			PROJECT MANAGER / ENGINEER				
5								

A PORTION OF SECTION 32, TOWNSHIP 25 NORTH, RANGE 06 EAST W.M.

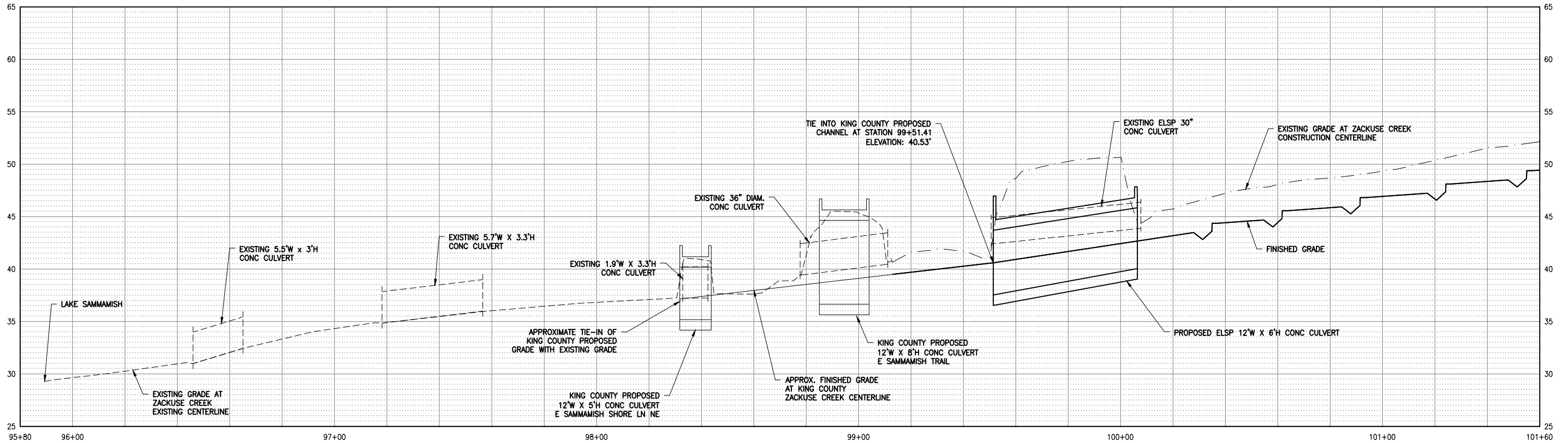

ZACKUSE CREEK CHANNEL PROFILE, LAKE SAMMAMISH TO STA 101+60

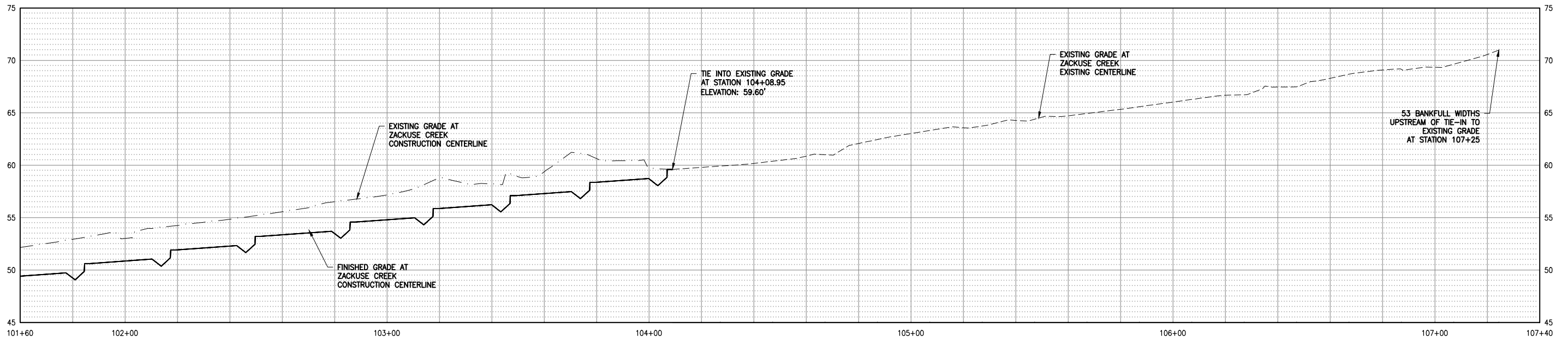

ZACKUSE CREEK CHANNEL PROFILE, STA 101+60 TO 53 BANKFULL WIDTHS UPSTREAM OF TIE IN POINT



ZACKUSE CREEK  
FISH WINDOW  
JULY 1 - SEPT 30

Know what's below.  
Call before you dig.

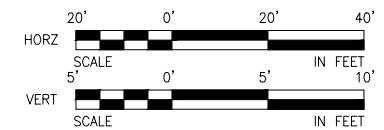

PRELIMINARY - NOT FOR CONSTRUCTION

ZACKUSE CREEK FISH PASSAGE AND STREAM RESTORATION PROJECT SAMMAMISH, WASHINGTON	NO.	REVISIONS	DATE	DATE: XX/XXX		STREAM CHANNEL PLAN AND PROFILE	SR02	
	1			DESIGNED BY:			SHEET OF	
	2			DRAWN BY:				
	3			REVIEWED BY:			19 31	
	4							
5								