

Lindsey Ozbolt

From: Lindsey Ozbolt
Sent: Wednesday, January 25, 2017 2:48 PM
To: 'Steve Roberts'
Subject: RE: Access concerns.

Hi Steve,

You should have a calendar invite from me for Friday at 11:30am. See you then.

Thanks,

Lindsey Ozbolt

Associate Planner | City of Sammamish | Department of Community Development
425.295.0527

From: Steve Roberts [mailto:steve@roberts.org]
Sent: Wednesday, January 25, 2017 1:38 PM
To: Lindsey Ozbolt <LOzbolt@sammamish.us>
Cc: Steve Leniszewski <SLeniszewski@sammamish.us>
Subject: Re: Access concerns.

Thanks Lindsey,

I'll be there on Friday at 11:30.

All the best,

-steve-

On Wed, Jan 25, 2017 at 11:28 AM, Lindsey Ozbolt <LOzbolt@sammamish.us> wrote:

Hello Steve,

Steve Leniszewski are available to meet with you on Friday, January 27th from 11:30am to 12:00pm at City Hall. If that time does not work for you, we can also be available on Thursday, January 26th from 2:00pm to 2:30pm.

Please let me know if either of these times work for you and I will send out a calendar invite.

Best,

Lindsey Ozbolt

Associate Planner | City of Sammamish | Department of Community Development

[425.295.0527](tel:425.295.0527)

From: Steve Roberts [mailto:steve@roberts.org]

Sent: Sunday, January 22, 2017 10:55 AM

To: Lindsey Ozbolt <LOzbolt@sammamish.us>

Cc: Steve Leniszewski <SLeniszewski@sammamish.us>; william rissberger <williamrissberger@comcast.net>; frankmckulka@comcast.net; Michelle Eden <mmeden@hotmail.com>; Jerry <jerryj27@msn.com>; Susan Roberts <susan@roberts.org>

Subject: Re: Access concerns.

Hi Lindsey,

Thank you very much. I assume that in addition to compiling comments and passing them on to the county that the city will also evaluate our concerns and upon merit will advocate on our behalf.

In that regard I would like to meet with you and/or Steve Leniszewski to review my specific ingress/egress concerns regarding my home which was permitted based on a requisite safe turning radius to access my garage. How can I set up an appointment with you?

Best regards,

Steve and Susan Roberts.

On Tue, Jan 10, 2017 at 4:03 PM, Lindsey Ozbolt <LOzbolt@sammamish.us> wrote:

Dear Mr. Roberts,

Thank you for contacting the City of Sammamish regarding the current Shoreline Substantial Development Permit Application for East Lake Sammamish Trail [Segment 2B \(SSDP2016-00415\)](#).

Your comments have been received and will be included in the project record. At the close of the comment period, all comments will be compiled and provided to King County for review and response. You will be included in future notices the City issues for this proposal.

Regards,

Lindsey Ozbolt

Associate Planner | City of Sammamish | Department of Community Development

[425.295.0527](tel:425.295.0527)

From: Steve Roberts [mailto:steve@roberts.org]

Sent: Tuesday, January 10, 2017 3:47 AM

To: Steve Leniszewski <SLeniszewski@sammamish.us>

Cc: Lindsey Ozbolt <LOzbolt@sammamish.us>; william rissberger <williamrissberger@comcast.net>; frankmckulka@comcast.net; Michelle Eden <mmeden@hotmail.com>; Jerry <jerryj27@msn.com>; Susan Roberts <susan@roberts.org>

Subject: Re: Access concerns.

Hi Steve,

I wanted to follow up with you regarding our meeting in September. As you may recall I had a concern that the county had plans on moving the trail substantially west impeding safe access to my property. At issue, widening the trail east, was the ditch that since the county had obtain the railroad easement had been, as we understood it, reclassified as a wet land. Having said that we have recently been advised that the trail will indeed be partially widened east and a culvert will be installed in place of the ditch. This is the start of good news for the four affected neighbors that live in that area. However in the county's preliminary plans they do propose also widening the trail west. You may recall that in our earlier discussion I mentioned that I had worked with former city employee, Rob Garwood, in the planning and permitting of our new home. (Permit No. B15-00019). In that regard, I did not ask the city for a building variance and was permitted using standard setbacks. In working with Mr. Garwood I was informed that even without a variance there were certain garage/driveway access requirements necessary to successfully obtain a permit to build. One of the things discussed was the turning radius to get into our garage and driveway. In working with Mr. Garwood that turning radius was based on the then, and current, trail fence and bollards and their distance to our home. (See attached site plan.) Moving that fence and bollards west would make turning into our garage a dangerous proposition involving multi-point turns adjacent to the trail. In addition with the help of Mr. Garwood and our architect we had designed our home such with the existing access we would not need to back out north

Exhibit 29
SSDP2016-00415
004700

across two neighbors lots to turn around to cross the trail but could back out south within our own property width to drive out safely in a forward gear.

Attached is a county produced map of the area. For clarity here is an annotated blow up of that map showing the 4 homes affected in this discussion.

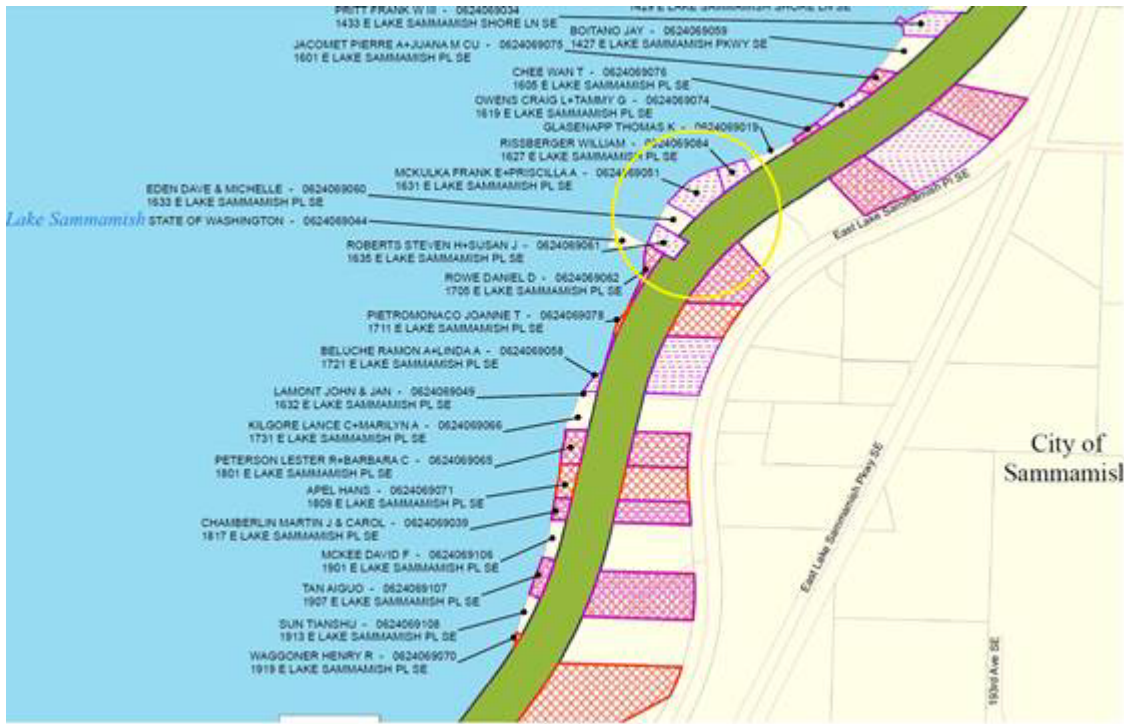

In general here is the list of my concerns with widening trail west past its current position.

1. The current crossing point for the trail would be narrowed at the Rissberger property (1627 E.L.S. PL SE) making general access even more precarious.
2. Myself (1635 E.L.S. PL SE) and the Edén's family (1633 E.L.S. PL SE) when leaving our properties must back out and back into the McKulka property's driveway (1631 E.L.S. PL SE). This becomes even more difficult with a west widening of the trail.
3. Currently there is just enough room for driving past the Edén's parked vehicles for me to access my property. If the trail is widened west then that will be impossible without some major changes to where/how the Edén's currently park.
4. If the trail is widened west then that tree as shown in the picture will have to be removed so that I can get to my property. That would be a shame. Not only for those neighbors that enjoy the tree but for the eagles that often use it as a perch.
5. As mentioned above, widening the trail west would cause issues for my property both **Exhibit 26** to **SSDP2016-00415** access and safety for ourselves and those on the trail. **004701**

The good news is that the county is proposing widening the trail east already and as we understand it they are only proposing widening the trail west by a few feet. Those few feet are precious and necessary for us for safe access and safe trail usage. Given that the county is planning on widening the trail east I would ask you that you continue to be our advocate and work with the county to widened it east the extent that we may have our current boundaries and access.

I am out of the country until the 20th but would very much like to meet with you upon my return if you have any questions at all. Also I'm sure that my neighbors, as cc'd in this email, would support the items mentioned and might also have additional concerns and suggestions.

Best regards,

Steve and Susan Roberts

1635 E.L.S. PL SE

Sammamish, WA

98075



On Fri, Sep 9, 2016 at 1:52 PM, Steve Leniszewski <SLeniszewski@sammamish.us> wrote:

Thanks. We'll attach it to the file.

Cheers,

Steve L.

From: Steve Roberts [mailto:steve@roberts.org]

Sent: Friday, September 9, 2016 1:20 PM

To: Steve Leniszewski <SLeniszewski@sammamish.us>

Subject: Access concerns.

Hi Steve,

Thanks for seeing me yesterday on no notice. I really appreciate it. Below are a couple of pictures showing you my access west of the trail. As mentioned we worked with Rob Garwood and he helped us understand at the time that even with the trail where it is now we would need all the distance to have a minimum acceptable turning radius. As I mentioned in our meeting prior to the county deciding that this was going to be a trail the ditch to the east was simple a ditch and as such was regularly backhowed to clean it out. So I've also attached my letter that I recently sent Kelly Donahue of the County concerning the ditch. In summary there is room for the trail to move east but moving it west will be a serious safety issue for us entering and certainly backing out of our garage on to the trail area.

Best regards,

Steve Roberts

1635 East Lake Sammamish PL SE



Exhibit 29
SSDP2016-00415
004704



VICINITY MAP

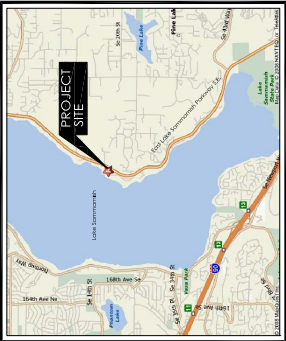

BUILDING CODE DATA:

BUILDING CODE: 2002 International Residential Code (IRC)
 ENVIRONMENTAL CODES: 2002 Washington State Energy Code (WSEC)
 SEISMIC DESIGN CATEGORY: D2
 BASIC WIND SPEED: 68 MPH
 MINIMUM SNOW LOAD: 25 LB/S.F.
 MAX. ASSUMED SOIL BEARING CAPACITY: 1,800 P.S.F.

GENERAL NOTES:

1. ALL ROOF DRAIN AND FOOTING DRAIN SHALL BE SEPARATED. TIGHTLINE EACH TO STORM DRAINAGE SYSTEM AS REQUIRED. SEE DETAIL.
2. ALL RECYCLED MATERIALS SHALL BE IMMEDIATELY REVOTED FROM THE SITE AND Hauled TO AN APPROVED DUMP SITE.
3. SEE LANSAGE AND ASB 101 FOR ADDITIONAL INFORMATION REGARDING DISCONNECT AND PROTECT EXISTING SANITARY SEWER STUB.
4. RECONNECT TO EXISTING STUB. PROTECT FROM DAMAGE DURING CONSTRUCTION. RECONNECT TO EXISTING UTILITIES.
5. ALL WORK REMAINS HIGHER THAN 4 FEET IN HEIGHT SHALL BE CONSTRUCTED TO MEET WASHINGTON STATE CODES AND REGULATIONS. ALL SITE AND FOUNDATION WORK SHALL BE REVIEWED AND MONITORED BY THE GEOTECHNICAL ENGINEER TO VERIFY COMPLIANCE WITH THE DESIGN CRITERIA.

DEMOLITION NOTES:

1. DISCONNECT AND CAP ALL EXISTING UTILITIES AS REQUIRED BY THE SERVING UTILITY AND CITY.
2. COMPLETE ROBERT CONTROL PROGRAM.
3. COMPLETE ASBESTOS ABATEMENT PROGRAM.
4. DEMOLITION SHALL BE FULLY INSURED COMPLETELY.
5. SURVEY DRAINAGE FOR SCOPE OF STRUCTURE DEMOLITION.
6. REMOVE ALL LANDSCAPE STRUCTURES TO THE EXTENT POSSIBLE WHILE IN A LEGAL MANNER.
7. REMOVE ALL DEBRIS FROM THE SITE AND DEPOSE OFF-SITE IN A LEGAL MANNER.
8. SEE DRAWINGS AND 101 FOR ADDITIONAL INFORMATION REGARDING DEMOLITION AND TESTS/INSURANCE.

LOT COVERAGE:

TOTAL LOT AREA: 3,695.5E
 ALLOWED IMPERVIOUS AREA @ 55%: 1,999 SF
 PROPOSED IMPROVEMENTS DRIP LINE OF NEW RESIDENCE: 1,920 SF
 PERVIOUS PAVING/GRADE SET PAVERS (@ 50% IMPERVIOUS): 77.5E
 PROPOSED IMPERVIOUS SURFACES (INCLUDES BUILDING ROOFLINE DRIVEWAY, WALKWAYS & DECKS): 1,947 SF

BUILDING HEIGHT:

- * AVERAGE EXISTING GRADE = 567.56/16 = 35.47'
 - * LOWER FLOOR ELEVATION = 34.00'
 - * MAIN FLOOR ELEVATION = 48.00'
 - * T/O PARAPET ELEVATION: 34.00' + 36.49' = 70.49'
 - * ALLOWABLE BUILDING HEIGHT FROM AVERAGE EXISTING GRADE: 70.47'
 - * IS GREATER THAN 70.49' OK
- (SEE DRAWING A51 FOR COMPLIANCE DIAGRAM)

LEGAL DESCRIPTION:

PARCEL A: THAT PORTION OF GOVERNMENT LOT 3 IN SECTION 5, TOWNSHIP 10 NORTH RANGE 6 EAST N.M., DESCRIBED AS FOLLOWS:
 BEGINNING AT AN IRON STAKE DRIVER IN THE GROUND PRIVATE INDICATION OF THE BEGINNING OF A SANTIAPISH AS SHOWN ON BLUEPRINT FILED WITH DEED RECORDS OF KING COUNTY SAID IRON STAKE MARKING THE NORTHWEST CORNER OF A TRACT UNDER KING COUNTY RECORDS NO. 28837A, RECORDS OF KING COUNTY, THENCE SOUTH 89°30'10" WEST 122.18 FEET TO THE TRUE POINT OF BEGINNING, THENCE CONTINUING THE TRUE POINT OF BEGINNING, THENCE CONTINUING SOUTHWESTERLY ALONG SAID NORTHWESTERLY BOUNDARY 40.75 FEET TO THE SHORE OF LAKE SANTIAPISH, THENCE NORTHERLY ALONG SAID SHORE 50 FEET, 612200' EAST FROM THE TRUE POINT OF BEGINNING, THENCE SOUTH 49°02'00" EAST 162.70 FEET TO THE TRUE POINT OF BEGINNING, ON OR LESS, TO THE TRUE POINT OF BEGINNING;
 TOGETHER WITH SHORELANDS OF THE SECOND CLASS AS SHOWN ON SAID MAP, BEING THE SHORELANDS OF THE FRONT OF ADJACENT TO OR ADJOINING THEREON, SITUATE IN THE COUNTY OF KING, STATE OF WASHINGTON.

THAT PORTION OF THE WESTERLY 25.0 FEET IN WIDTH OF THE SOUTHWEST QUARTER SECTION 5, TOWNSHIP 10 NORTH RANGE 6 EAST N.M., DESCRIBED AS FOLLOWS:
 PACIFIC RAILWAY COMPANY 100.0 FOOT WIDE SANTIAPISH BRANCH LINE RIGHT-OF-WAY AS CONVERTED 500.0 FEET WIDE ON EACH SIDE OF SAID RAILROAD AND SAID MAIN TRACK CONTAINING AS NOW LOCATED GOVERNMENT LOT 3 IN SECTION 5, TOWNSHIP 10 NORTH RANGE 6 EAST N.M.), DESCRIBED AS FOLLOWS:
 BEGINNING AT AN IRON STAKE DRIVER IN THE GROUND AT THE INTERSECTIONS OF THE CENTER LINE OF A SANTIAPISH AS SHOWN ON BLUEPRINT FILED WITH DEED RECORDS UNDER KING COUNTY RECORDING NO. 28837A, RECORDS OF KING COUNTY, THENCE NORTH 89°30'10" WEST 122.18 FEET TO THE TRUE POINT OF BEGINNING, THENCE SOUTH 89°30'10" WEST 122.18 FEET TO THE TRUE POINT OF BEGINNING, THENCE CONTINUING THE TRUE POINT OF BEGINNING, THENCE CONTINUING SOUTHWESTERLY ALONG SAID NORTHWESTERLY BOUNDARY 40.75 FEET TO THE SHORE OF LAKE SANTIAPISH, THENCE NORTHERLY ALONG SAID SHORE 50 FEET, 612200' EAST FROM THE TRUE POINT OF BEGINNING, THENCE SOUTH 49°02'00" EAST 162.70 FEET TO THE TRUE POINT OF BEGINNING, ON OR LESS, TO THE TRUE POINT OF BEGINNING;
 TOGETHER WITH SHORELANDS OF THE SECOND CLASS AS SHOWN ON SAID MAP, BEING THE SHORELANDS OF THE FRONT OF ADJACENT TO OR ADJOINING THEREON, SITUATE IN THE COUNTY OF KING, STATE OF WASHINGTON.

LOT ZONING:

LOT ZONING: R-4
 LOT SIZE: 3,695.5E
 LOT SLOPE: 14.6E
 ALLOWED IMPERVIOUS AREA: 998 MAX.
 BASE BUILDING HEIGHT: 35 FEET FROM AVERAGE EXISTING GRADE
 SETBACK - FRONT YARD: 5 FEET
 SETBACK - REAR YARD: 5 FEET MIN. TOTAL BOTH SIDES OF 15 FEET MIN. EXCEPT FOR MAJOR BUILDING ELEMENTS, BAYETS, ETC. UP TO 8'.
 SETBACK - SIDE YARDS: 35 FEET FROM AVERAGE EXISTING GRADE

BUILDING DATA:

1X10 STORY HOUSE W/ BASEMENT:
 BASEMENT HEATED AREA: 1,341 SF
 MAIN FLOOR HEATED AREA: 1,783 SF
 UPPER FLOOR HEATED AREA: 1,993 SF
 TOTAL HEATED AREA: 5,097 SF
 TOTAL UNHEATED AREA: 1,603 SF
 TOTAL ENCLOSED BUILDING AREA: 5,800 SF
 PORCHES & DECKS: 606 SF

DATE	BY	DESCRIPTION
1/8/21	BOB	PERMIT REVISION SUBMITTAL

Roberts Residence
 1635 E. Lake Sammamish Pl S.E.
 Sammamish, Washington 98075
 Parcel #: 062406-9061
SITE PLAN

ROGER MCPHERSON DESIGN
 21626 SE 28th ST, SAMMAMISH WA 98075/1725
 PH: 425 391 3333 FAX: 425 357 2841



A1.0
DRAWING NUMBER

OF DRAWINGS

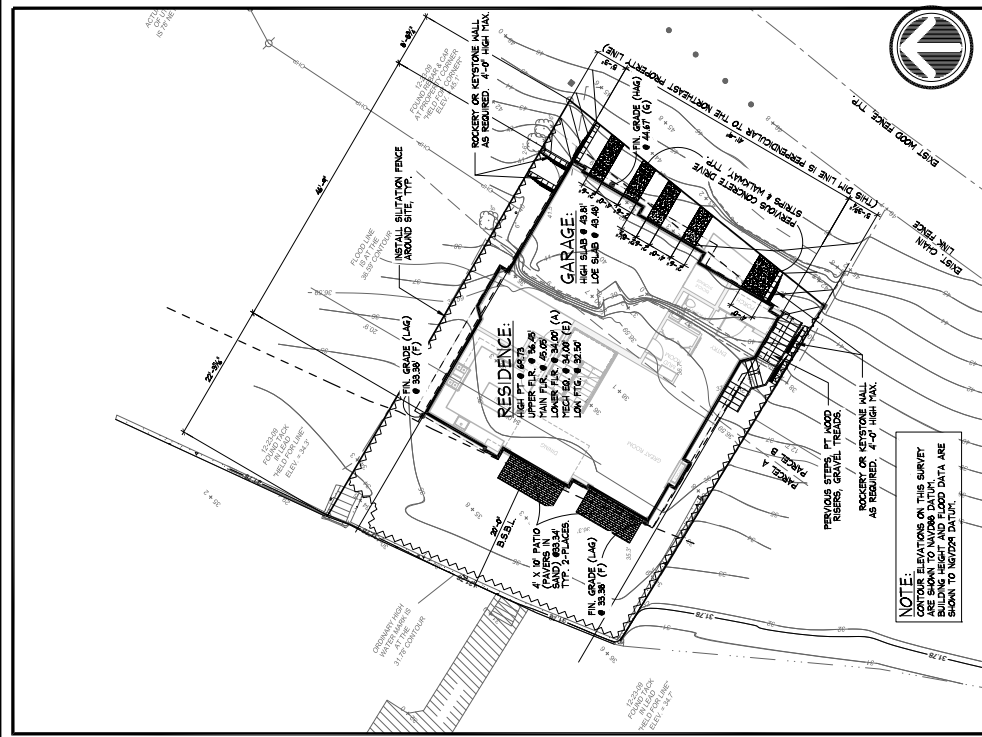

S I T E P L A N

Scale: 1" = 20'-0"

PROJECT DATA:

PARCEL #: 062406-9061
 1635 E. LAKE SAMMAMISH PLACE S.E.
 SAMMAMISH, WA 98075
PROPERTY OWNER: STEVE & SUSAN ROBERTS
ARCHITECT: MCPHERSON CONSTRUCTION & DESIGN
 2006 SE 30th, Sammamish WA 98075-1725
 PH: (425) 391-3333 FAX: (425) 357-2841
ENGINEER: BO STRUCTURAL ENGINEERS
 8300 24th St S.E.
 BELLEVUE, WASHINGTON 98008
 PH: (425) 746-2445

SITE DRAINAGE:

1. CONNECT ALL FOOTING DRAINS AND TIGHTLINE DIRECT TO DRAINAGE OUTFALL AT EDGE OF WATER.
2. CONNECT ALL ROOF DRAINS (SEPARATE FROM FOOTING DRAINS) AND TIGHTLINE TO THE DRAINAGE OUTFALL AT EDGE OF WATER.
3. CONNECT ALL ROOF DRAINS AND TIGHTLINE THROUGH THE DOWNWATER SEPARATOR INTO THE ROOF DRAIN SYSTEM.
4. FALTED DOWNWATER SEPARATORS TO SHEET DOWN TO SIDES OF DRIVE.

NOTE:
 CONTAIN ELEVATIONS ON THIS SURVEY ARE SHOWN TO NEAREST DATUM. FINISH ELEVATIONS ON THIS SURVEY ARE SHOWN TO NEAREST DATUM.











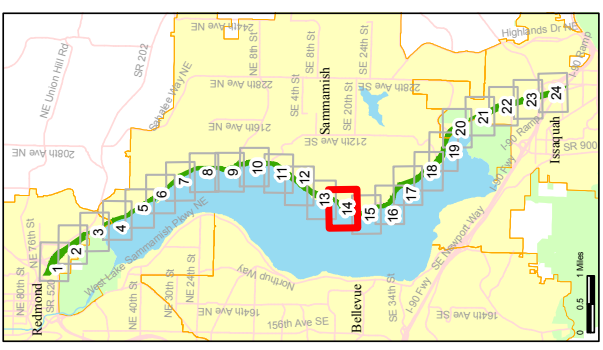

Exhibit 26
SSDP2016-00415
004706

POINT	EXST. GRADE	COUNT
A	33.66	1
B	32.21	1
C	32.31	1
D	32.31	1
E	32.21	1
F	33.41	1
G	34.31	1
H	34.31	1
I	36.41	1
J	37.41	1
K	37.66	1
L	38.51	1
M	38.51	1
N	38.71	1
O	38.81	1
P	38.81	1
Q	38.81	1
TOTAL EXST. GRADE		16
AVERAGE EXST. GRADE		35.47

East Lake Sammamish Trail Railroad Right of Way Historical Acquisitions

Legend

-  Deed to Railroad from Private Party
-  Land Grant
-  Easement
-  Adverse Possession
-  Court of Claims Plaintiff
-  Special Use Permit
-  King County Parks Property outside RR ROW
-  Other Parks
-  Tax Parcels

King County
Department of
Natural Resources and Parks
Parks Division
July 29, 2014



0 100 200 300 400 500 Feet

This information has been prepared by King County Parks and Recreation. It is provided for informational purposes only. King County Parks and Recreation does not warrant, represent, or guarantee the accuracy, completeness, or reliability of this information. King County Parks and Recreation is not responsible for any general, special, indirect, incidental, or consequential damages including, but not limited to, lost profits, lost data, or any other damages, arising from the use of this information. The information contained on this map, any sale of this map, or information on this map is prohibited except by written permission of King County.

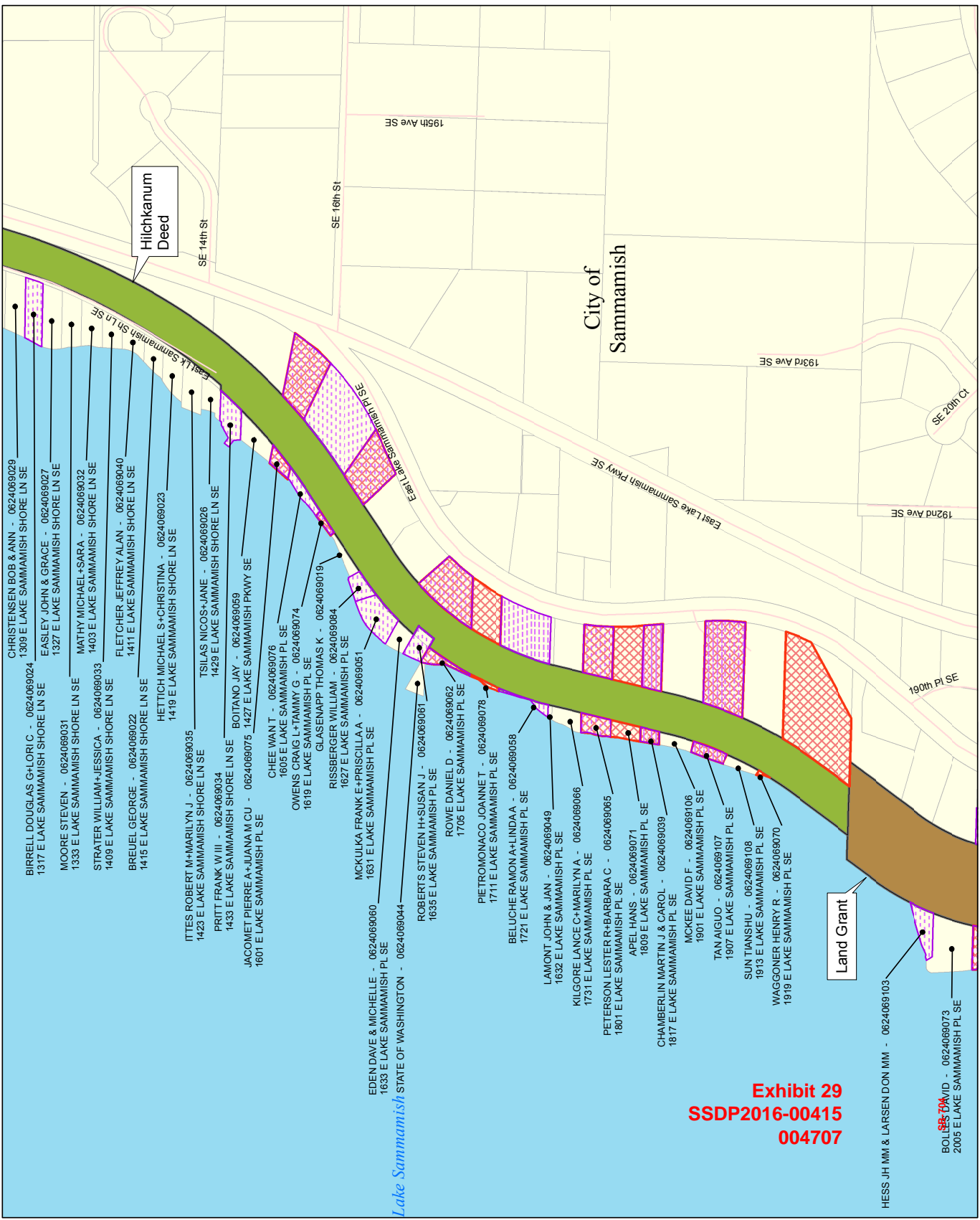

Exhibit 29
SSDP2016-00415
004707

Lindsey Ozbolt

From: Lindsey Ozbolt
Sent: Wednesday, January 25, 2017 11:08 AM
To: 's.j.rowland@comcast.net'
Subject: RE: Comments to SSDP, Eastlake Sammamish Trail Segment 2B - SSDP2016-00415, Affecting Our Tax Parcel 357530015506

Dear Joseph and Shelly,

Thank you for contacting the City of Sammamish regarding the current Shoreline Substantial Development Permit Application for East Lake Sammamish Trail Segment 2B (SSDP2016-00415).

Your comments have been received and will be included in the project record. At the close of the comment period, all comments will be compiled and provided to King County for review and response. You will be included in future notices the City issues for this proposal.

Regards,

Lindsey Ozbolt

Associate Planner | City of Sammamish | Department of Community Development
425.295.0527

From: s.j.rowland@comcast.net [mailto:s.j.rowland@comcast.net]
Sent: Wednesday, January 25, 2017 10:39 AM
To: Lindsey Ozbolt <LOzbolt@sammamish.us>
Subject: Comments to SSDP, Eastlake Sammamish Trail Segment 2B - SSDP2016-00415, Affecting Our Tax Parcel 357530015506

Dear Ms. Ozbolt:

We are writing to you today in response to the document, "Notice of Application for Shoreline Substantial Development Permit (SSDP), East Lake Sammamish Trail Segment 2B," dated 12/28/16, that we received in the mail early January 2017.

We, Shelly and Joseph Rowland, are the legal property owners of Tax Parcel #357530015506. On January 17th, we met with the King County staff at Sammamish City Hall and had an opportunity to review the 60% permit plans. We would like to state that they were very helpful in assisting us.

Our recreational waterfront parcel is located on the following pages we reviewed: G3, EX21, and AL38. The staff highlighted in yellow our parcel which indicated that we had met with them, and correctly identified our property. Our major concern and comment is that our existing access to our property is being eliminated with no replacement showing at this time. Presently, (as noted on page EX21 and station 467 + 80), we access our property through an existing gate in the trail fence. This gate has our own lock on it and is used only by us. During the construction of the original gravel trail and fence, this gate was installed to provide access directly to our property. Once entering the gate we proceed down a well established and constructed "paver staircase." From the bottom of this staircase there is a well groomed gravel path approximately 25 feet in length that leads directly to our property. Please note that the referenced gate, stairs, and path are in direct line with our property.

lines. We regularly maintain both the stairs and the gravel path. Please see the attached 3 photos to be helpful.

On page AL38 of the plans, note #19 is located next to our gate and stairs, and on the adjacent legend, note #19 states that our stairs and gate are to be removed/eliminated. This is unacceptable to us. We feel that our present access is well established, and its elimination will result in an adverse impact to the value of our property. We formally request that the final construction design and documents show a replacement access gate and a replacement staircase in alignment with where it currently exists leading directly to our property.

We look forward to working with the King County design team to satisfy our request, and it is our hope to resolve this access replacement issue without the need for us to retain legal representation. Thank you.

Sincerely,

Joseph (Joe) Rowland, and Shelly Rowland
206-354-1303; 206-354-1150
s.j.rowland@comcast.net



ALL CITY
FENCE CO

PROPERTY
PROTECTED

Exhibit 28
SSDP 2016-00415
004710

CITY
CE CO.
Seattle, Washington

CAMERA!

Exhibit 29
SSDP2016-00415
004711



Exhibit 29
SSDP2016-00415
004712

Lindsey Ozbolt

From: Lindsey Ozbolt
Sent: Friday, January 27, 2017 9:35 AM
To: 'benrubio@outlook.com'
Subject: RE: Please Approve the Permit for Segment 2B of the ELST

Dear Salvador,

Thank you for contacting the City of Sammamish regarding the current Shoreline Substantial Development Permit Application for East Lake Sammamish Trail Segment 2B (SSDP2016-00415).

Your comments have been received and will be included in the project record. At the close of the comment period, all comments will be compiled and provided to King County for review and response. You will be included in future notices the City issues for this proposal.

Regards,

Lindsey Ozbolt
Associate Planner | City of Sammamish | Department of Community Development
425.295.0527

-----Original Message-----

From: Salvador Rubio [mailto:benrubio@outlook.com]
Sent: Wednesday, January 25, 2017 5:41 PM
To: Lindsey Ozbolt <LOzbolt@sammamish.us>
Subject: Please Approve the Permit for Segment 2B of the ELST

Dear

Dear city of Sammamish,

I'm writing to express my support for completing the ELST and approving permit SSDP2016-00415.

Please approve the trail permit, as submitted, so that users of all ages and abilities can safely use the trail. A trail built to national standards (AASHTO), that is 12 ft, plus 2 ft gravel shoulders, will allow for safe use by a variety of different users, including people who walk and bike.

As proposed in the permit, priority at trail crossings should be given to the trail and trail users. Consistent crossing priority is intuitive and safe for users of both the trail and the driveways and roads that cross the trail.

When complete, the trail will be an even greater community amenity, and provide a safe option for people who bike to travel to and through Sammamish.

One of my family's favorite activities is biking. It's a healthy, easy way to bond, get exercise and have fun. This permit will improve the safety in one of the best trails in the area. We'd be able to bike from the tip of Lake Washington to the bottom of Lake Sammamish on fantastic, safe trails. Please complete the trail.

Exhibit 29
SSDP2016-00415
004713

Sincerely,

Salvador Rubio
14704 104th Ave NE
Bothell, WA 98011
4257865941

RE: Please Approve the Permit for Segment 2B of the ELST

Lindsey Ozbolt

Mon 1/23/2017 9:03 AM

To: sreenivas_s@hotmail.com <sreenivas_s@hotmail.com>;

Dear Sreenivas,

Thank you for contacting the City of Sammamish regarding the current Shoreline Substantial Development Permit Application for East Lake Sammamish Trail Segment 2B (SSDP2016-00415).

Your comments have been received and will be included in the project record. At the close of the comment period, all comments will be compiled and provided to King County for review and response. You will be included in future notices the City issues for this proposal.

Regards,

Lindsey Ozbolt

Associate Planner | City of Sammamish | Department of Community Development
425.295.0527

-----Original Message-----

From: Sreenivas Simhadri [mailto:sreenivas_s@hotmail.com]

Sent: Saturday, January 21, 2017 7:49 AM

To: Lindsey Ozbolt <LOzbolt@sammamish.us>

Subject: Please Approve the Permit for Segment 2B of the ELST

Dear

Dear city of Sammamish,

I'm writing to express my support for completing the ELST and approving permit SSDP2016-00415.

Please approve the trail permit, as submitted, so that users of all ages and abilities can safely use the trail. A trail built to national standards (AASHTO), that is 12 ft, plus gravel shoulders, will allow for safe use by a variety of different users, including people who walk and bike.

As proposed in the permit, priority at trail crossings should be given to the trail and trail users. Consistent crossing priority is intuitive and safe for users of both the trail and the driveways and roads that cross the trail.

When complete, the trail will be an even greater community amenity than in it's interim state, and will provide a safe option for people who bike to travel to and through Sammamish. Please complete the trail.

Exhibit 29
SSDP2016-00415
004715

Lindsey Ozbolt

From: Lindsey Ozbolt
Sent: Wednesday, January 25, 2017 10:44 AM
To: 'sudha@ieee.org'
Subject: RE: Please Approve the Permit for Segment 2B of the ELST

Dear Subramania,

Thank you for contacting the City of Sammamish regarding the current Shoreline Substantial Development Permit Application for East Lake Sammamish Trail Segment 2B (SSDP2016-00415).

Your comments have been received and will be included in the project record. At the close of the comment period, all comments will be compiled and provided to King County for review and response. You will be included in future notices the City issues for this proposal.

Regards,

Lindsey Ozbolt
Associate Planner | City of Sammamish | Department of Community Development
425.295.0527

-----Original Message-----

From: Subramania Sudharsanan [mailto:sudha@ieee.org]
Sent: Tuesday, January 24, 2017 9:49 PM
To: Lindsey Ozbolt <LOzbolt@sammamish.us>
Subject: Please Approve the Permit for Segment 2B of the ELST

Dear

Dear city of Sammamish,

I'm writing to express my support for completing the ELST and approving permit SSDP2016-00415.

Please approve the permit, as submitted.

Approval of the permit will advance completion of the 44 mile regional trail system between Seattle and the foothills of the Cascades. The trail, as proposed in the permit, will provide a safe walking and biking route through Sammamish. Please support the proposed trail widths, which reflect industry standards (AASHTO).

A 12ft trail with 2ft shoulders will create a safe trail with space for the various different uses... from people running to people riding a bike. Please approve the permit, including the proposed width of the trail.

I currently ride on the partially completed trail coming all the way from Woodinville. I respect the residents, the walkers, and other cyclists. When completed, this is going to be a great trail for all of us to enjoy, including the residents along the trail.

Ensuring crossing priority for the trail is an important safety issue. Giving priority to the trail when roads and driveways cross the path will be intuitive for all users. The trail alignment, as proposed in the permit, provides sight lines for good visibility for people on the trail and people crossing the trail at trail intersections.

Please approve the permit, as proposed, with expediency.

Sincerely,

Subramania Sudharsanan
19345 132nd PL NE
Woodinville, WA 98072
425-415-1280

Lindsey Ozbolt

From: Lindsey Ozbolt
Sent: Friday, January 27, 2017 9:46 AM
To: 'swaze17@aol.com'
Subject: RE: Please Approve the Permit for Segment 2B of the ELST

Dear Suzanne,

Thank you for contacting the City of Sammamish regarding the current Shoreline Substantial Development Permit Application for East Lake Sammamish Trail Segment 2B (SSDP2016-00415).

Your comments have been received and will be included in the project record. At the close of the comment period, all comments will be compiled and provided to King County for review and response. You will be included in future notices the City issues for this proposal.

Regards,

Lindsey Ozbolt
Associate Planner | City of Sammamish | Department of Community Development
425.295.0527

-----Original Message-----

From: Suzanne Sullivan [mailto:swaze17@aol.com]
Sent: Wednesday, January 25, 2017 8:00 PM
To: Lindsey Ozbolt <LOzbolt@sammamish.us>
Subject: Please Approve the Permit for Segment 2B of the ELST

Dear

Dear city of Sammamish,

I'm writing to express my support for completing the ELST and approving permit SSDP2016-00415.

It is important to me to have this bike trail completed.

Please approve the permit, as submitted.

Approval of the permit will advance completion of the 44 mile regional trail system between Seattle and the foothills of the Cascades. The trail, as proposed in the permit, will provide a safe walking and biking route through Sammamish. Please support the proposed trail widths, which reflect industry standards (AASHTO).

A 12ft trail with 2ft shoulders will create a safe trail with space for the various different uses... from people running to people riding a bike. Please approve the permit, including the proposed width of the trail.

Ensuring crossing priority for the trail is an important safety issue. Giving priority to the trail when roads and driveways cross the path will be intuitive for all users. The trail alignment, as proposed in the permit, provides sight lines for good visibility for people on the trail and people crossing the trail at trail intersections.

Exhibit 29
SSDP2016-00415
004719

Please approve the permit, as proposed, with expediency.

Sincerely,
Suzanne Sullivan

Suzanne Sullivan
6920 California Ave SW
Seattle, WA 98136
914-261-8481

RE: Please Approve the Permit for Segment 2B of the ELST

Lindsey Ozbolt

Mon 1/23/2017 11:44 AM

To: momtomnw@comcast.net <momtomnw@comcast.net>;

Dear Susi,

Thank you for contacting the City of Sammamish regarding the current Shoreline Substantial Development Permit Application for East Lake Sammamish Trail Segment 2B (SSDP2016-00415).

Your comments have been received and will be included in the project record. At the close of the comment period, all comments will be compiled and provided to King County for review and response. You will be included in future notices the City issues for this proposal.

Regards,

Lindsey Ozbolt

Associate Planner | City of Sammamish | Department of Community Development
425.295.0527

-----Original Message-----

From: Susi Tom [<mailto:momtomnw@comcast.net>]

Sent: Monday, January 23, 2017 11:27 AM

To: Lindsey Ozbolt <LOzbolt@sammamish.us>

Subject: Please Approve the Permit for Segment 2B of the ELST

Dear

Dear city of Sammamish,

I am a 57 yr old female cyclist who thoroughly enjoys cycling the trail and avoiding the heavy car traffic on the main thoroughfare. I am a member of the Lakemont Ladies Cycling club (totally recreational) and we use the trail at least 3 days a week because one of our regular routes is from Meerwood Park to Marymoor Park, which is 25 miles round trip. We always observe the speed limit and try to be friendly and courteous to other users. We all appreciate this beautiful public space which I consider to be a GEM in our community and are so happy to see people of all ages out exercising, and enjoying nature in a safe way! It is so nice to see young children learning to ride their bikes and having plenty of width to do so. Also, it is so nice to have an uninterrupted, long trail with worthwhile destinations on both ends (shopping and restaurants in Redmond and Issaquah) and public beaches along the way. Families, commuters, and others should be able to safely walk or bike to these destinations and not have to drive a car. I think it would be ridiculous to not complete the trail! So much has been completed so far, why not just complete the whole thing? Our cycling club has to go to trouble of switching to the main road, which is disruptive and putting us back out onto the dangerous road. People will be so thankful for this lovely public space now and in years to come!

I'm writing to express my support for completing the ELST and approving permit SSDP2016-00415.

Exhibit 29
SSDP2016-00415

Please approve the permit, as submitted.

Approval of the permit will advance completion of the 44 mile regional trail system between Seattle and the foothills of the Cascades. The trail, as proposed in the permit, will provide a safe walking and biking route through Sammamish. Please support the proposed trail widths, which reflect industry standards (AASHTO).

A 12ft trail with 2ft shoulders will create a safe trail with space for the various different uses... from people running to people riding a bike. Please approve the permit, including the proposed width of the trail.

Ensuring crossing priority for the trail is an important safety issue. Giving priority to the trail when roads and driveways cross the path will be intuitive for all users. The trail alignment, as proposed in the permit, provides sight lines for good visibility for people on the trail and people crossing the trail at trail intersections.

Please approve the permit, as proposed, with expediency.

Sincerely,

Susi Tom
4436 192nd PL SE
Issaquah, WA 98027
425 503 9041

Lindsey Ozbolt

From: Lindsey Ozbolt
Sent: Wednesday, January 25, 2017 3:53 PM
To: 'SHO Organization'
Subject: RE: ELST Segment 2B Design

Dear SHO Board,

Thank you for contacting the City of Sammamish regarding the current Shoreline Substantial Development Permit Application for East Lake Sammamish Trail Segment 2B (SSDP2016-00415).

Your comments have been received and will be included in the project record. At the close of the comment period, all comments will be compiled and provided to King County for review and response. You will be included in future notices the City issues for this proposal.

Regards,

Lindsey Ozbolt

Associate Planner | City of Sammamish | Department of Community Development
425.295.0527

From: SHO Organization [mailto:sho5.org@gmail.com]
Sent: Wednesday, January 25, 2017 12:18 PM
To: Lindsey Ozbolt <LOzbolt@sammamish.us>
Subject: ELST Segment 2B Design

SHO supports improvement of the ELST and acknowledges that King County has a limited easement to improve the trail, except across about 27 properties where the railroad never bothered to obtain an easement. Some of the owners of these properties have filed a lawsuit over ownership; SHO is not part of this lawsuit.

With the inter-local agreement between the City and the County no longer giving the County the privilege of applying to itself for the Substantial Shoreline Development Permit (SSDP), the City staff is now totally responsible for review of the ELST segment 2B design.

SHO believes that the City staff needs to pay particular attention to the following City of Sammamish regulations that constrict ELST improvement:

1. The improved trail must be aligned with the existing interim trail. 21A.30.210 Trail corridors – Development standards.
2. When the improved trail is not within a critical areas buffers, the total trail width should not exceed 16 feet. 21A.30.210 Trail corridors – Development standards. The AASHTO standards for public multi-use paved trails (Guide for the Development of Bicycle Facilities, 1999, as amended, American Association of State Highway and Transportation Officials) state that 12 feet of paving meets the level of service predicted by the County plus 2-foot gravel shoulders on each side of the paving.
3. When the improved trail is within a wetland buffer, the total trail width should not exceed 14 feet. 21A.50.310 Wetlands – Mitigation requirements. Mitigation sequencing requires that the width of the

Exhibit 29
SSDP2016-00415
004723

trail be minimized within wetland buffers; the minimum paved width according to AASHTO standards is 10 feet.

4. When the improved trail is within a stream buffer, the total trail width should not exceed 14 feet.
21A.50.350 Streams – Mitigation requirements. Mitigation sequencing requires that the width of the trail be minimized within stream buffers; the minimum paved width according to AASHTO standards is 10 feet.

SHO submits that the City should not approve the SSDP when the County's design, as reflected in the 60% plans, is in conflict with City code in these areas. Appropriate design changes should be required and the 90% plans reviewed by the City to ensure that the conflicts have been eliminated. Only then should the SSDP be approved (subject to other considerations as well, e.g., ownership).

With the trail improved according to City regulations, the impact to the environment will be minimized. Any mitigation required for disruption of the environment will also be minimized.

SHO does question allowing the County to mitigate upon land that the County does not have fee interest or permission from the owner with fee interest. Creating a wetland or a wetland buffer on someone else's property should not be permitted.

Regards,
SHO Board

RE: Please Approve the Permit for Segment 2B of the ELST

Lindsey Ozbolt

Mon 1/23/2017 9:03 AM

To:goldendogy@gmail.com <goldendogy@gmail.com>;

Dear Tina,

Thank you for contacting the City of Sammamish regarding the current Shoreline Substantial Development Permit Application for East Lake Sammamish Trail Segment 2B (SSDP2016-00415).

Your comments have been received and will be included in the project record. At the close of the comment period, all comments will be compiled and provided to King County for review and response. You will be included in future notices the City issues for this proposal.

Regards,

Lindsey Ozbolt
Associate Planner | City of Sammamish | Department of Community Development
425.295.0527

-----Original Message-----

From: Tina Anderson [<mailto:goldendogy@gmail.com>]
Sent: Saturday, January 21, 2017 7:58 AM
To: Lindsey Ozbolt <LOzbolt@sammamish.us>
Subject: Please Approve the Permit for Segment 2B of the ELST

Dear

Dear city of Sammamish,

I'm writing to express my support for completing the ELST and approving permit SSDP2016-00415.

Please approve the permit, as submitted.

Approval of the permit will advance completion of the 44 mile regional trail system between Seattle and the foothills of the Cascades. The trail, as proposed in the permit, will provide a safe walking and biking route through Sammamish. Please support the proposed trail widths, which reflect industry standards (AASHTO).

I run and bike on this trail almost weekly. Having the trail paved would make it more accessible for those in wheelchairs and baby strollers. I value accessibility for all.

A 12ft trail with 2ft shoulders will create a safe trail with space for the various different uses of the trail... from **Exhibit 29** to riding a

<https://mail.sammamish.us/owa/#viewmodel=ReadMessageItem&ItemID=...uKY3twkOpC5YzL9hvVgAAAtHKAAAA&IsPrintView=1&wid=32&ispos> **SSDP2016-00415** **004725** Page 1 of 2

bike. Please approve the permit with the trail widths as proposed.

Ensuring crossing priority for the trail is an important safety issue. Giving priority to the trail when roads and driveways cross the path will be intuitive for all users, whether in a vehicle, on foot, or on a bike. The trail alignment, as proposed in the permit, provides sight lines for good approach visibility for people on the trail and people crossing the trail.

Please approve the permit, as proposed, with expediency.

Tina Anderson
837 Front St. S
Issaquah, WA 98027
4253928150

RE: Please Approve the Permit for Segment 2B of the ELST

Lindsey Ozbolt

Mon 1/23/2017 9:07 AM

To: txomin@comcast.net <txomin@comcast.net>;

Dear Txomin,

Thank you for contacting the City of Sammamish regarding the current Shoreline Substantial Development Permit Application for East Lake Sammamish Trail Segment 2B (SSDP2016-00415).

Your comments have been received and will be included in the project record. At the close of the comment period, all comments will be compiled and provided to King County for review and response. You will be included in future notices the City issues for this proposal.

Regards,

Lindsey Ozbolt

Associate Planner | City of Sammamish | Department of Community Development
425.295.0527

-----Original Message-----

From: Txomin Barturen [<mailto:txomin@comcast.net>]

Sent: Saturday, January 21, 2017 5:08 AM

To: Lindsey Ozbolt <LOzbolt@sammamish.us>

Subject: Please Approve the Permit for Segment 2B of the ELST

Dear

Dear city of Sammamish,

I'm writing to express my support for completing the ELST and approving permit SSDP2016-00415.

I am a long time resident of Issaquah and use the ELST regularly as a pedestrian and cyclist. Having an option to not have to deal with the traffic conditions on East Lake Sammamish Parkway will improve safety for all users. I urge you to consider the needs and safety of the many over the few.

Please approve the permit, as submitted.

Approval of the permit will advance completion of the 44 mile regional trail system between Seattle and the foothills of the Cascades. The trail, as proposed in the permit, will provide a safe walking and biking route through Sammamish. Please support the proposed trail widths, which reflect industry standards (AASHTO).

Exhibit 29
SSDP2016-00415
00415

A 12ft trail with 2ft shoulders will create a safe trail with space for the various different uses of the trail... from running to riding a bike. Please approve the permit with the trail widths as proposed.

Ensuring crossing priority for the trail is an important safety issue. Giving priority to the trail when roads and driveways cross the path will be intuitive for all users, whether in a vehicle, on foot, or on a bike. The trail alignment, as proposed in the permit, provides sight lines for good approach visibility for people on the trail and people crossing the trail.

Please approve the permit, as proposed, with expediency.

Txomin Barturen
68 Sunset Ct NW
Issaquah, WA 98027
425-427-8846

Exhibit 29
SSDP2016-00415
004728

Lindsey Ozbolt

From: Lindsey Ozbolt
Sent: Wednesday, January 25, 2017 10:34 AM
To: 'Tlblues@gmail.com'
Subject: RE: Please Approve the Permit for Segment 2B of the ELST

Dear Terry,

Thank you for contacting the City of Sammamish regarding the current Shoreline Substantial Development Permit Application for East Lake Sammamish Trail Segment 2B (SSDP2016-00415).

Your comments have been received and will be included in the project record. At the close of the comment period, all comments will be compiled and provided to King County for review and response. You will be included in future notices the City issues for this proposal.

Regards,

Lindsey Ozbolt
Associate Planner | City of Sammamish | Department of Community Development
425.295.0527

-----Original Message-----

From: Terry Bridges [mailto:Tlblues@gmail.com]
Sent: Tuesday, January 24, 2017 9:04 PM
To: Lindsey Ozbolt <LOzbolt@sammamish.us>
Subject: Please Approve the Permit for Segment 2B of the ELST

Dear

Dear city of Sammamish,

I'm writing to express my support for completing the ELST and approving permit SSDP2016-00415.

Please approve the permit, as submitted.

Approval of the permit will advance completion of the 44 mile regional trail system between Seattle and the foothills of the Cascades. The trail, as proposed in the permit, will provide a safe walking and biking route through Sammamish. Please support the proposed trail widths, which reflect industry standards (AASHTO).

A 12ft trail with 2ft shoulders will create a safe trail with space for the various different uses of the trail... from running to riding a bike. Please approve the permit with the trail widths as proposed.

Ensuring crossing priority for the trail is an important safety issue. Giving priority to the trail when roads and driveways cross the path will be intuitive for all users, whether in a vehicle, on foot, or on a bike. The trail alignment, as proposed in the permit, provides sight lines for good approach visibility for people on the trail and people crossing the trail.

Please approve the permit, as proposed, with expediency.

Exhibit 29
SSDP2016-00415
004729

Terry Bridges
16004 NE 195th Street
Woodinville, WA 98072
425-256-1317

RE: Sammamish Trail Revisions

Lindsey Ozbolt

Tue 1/17/2017 10:23 AM

To: TC <timcss74@gmail.com>;

Dear Tim and Katie Comer,

Thank you for contacting the City of Sammamish regarding the current Shoreline Substantial Development Permit Application for East Lake Sammamish Trail Segment 2B (SSDP2016-00415).

Your comments have been received and will be included in the project record. At the close of the comment period, all comments will be compiled and provided to King County for review and response. You will be included in future notices the City issues for this proposal.

Regards,

Lindsey Ozbolt

Associate Planner | City of Sammamish | Department of Community Development
425.295.0527

-----Original Message-----

From: TC [<mailto:timcss74@gmail.com>]

Sent: Sunday, January 15, 2017 3:43 PM

To: Lindsey Ozbolt <LOzbolt@sammamish.us>

Subject: Sammamish Trail Revisions

I see there are plans to add culverts, walls and fences at +389-390 and on driveway 10

driveway 10 is privately owned by us homeowners and any revisions will need to be reviewed with and approved by us.

the bag wall and fencing is a issue as is any damage to the large trees

tim and katie comer

829 e lk sammamish sh ln se
sammamish wa 98075

Sent from my iPhone

Exhibit 29
SSDP2016-00415
004731

Lindsey Ozbolt

From: Lindsey Ozbolt
Sent: Friday, January 27, 2017 10:37 AM
To: 'Ted Davis'
Subject: RE: Comments on the Shoreline Substantial Development Plan

Dear Ted,

Thank you for contacting the City of Sammamish regarding the current Shoreline Substantial Development Permit Application for East Lake Sammamish Trail Segment 2B (SSDP2016-00415).

Your comments have been received and will be included in the project record. At the close of the comment period, all comments will be compiled and provided to King County for review and response. You will be included in future notices the City issues for this proposal.

Regards,

Lindsey Ozbolt

Associate Planner | City of Sammamish | Department of Community Development
425.295.0527

From: Ted Davis [mailto:ted.Davis@comcast.net]
Sent: Thursday, January 26, 2017 2:04 PM
To: Lindsey Ozbolt <LOzbolt@sammamish.us>
Subject: Comments on the Shoreline Substantial Development Plan

Date: January 26, 2017

Lindsey Osbolt lozbolt@sammamish.us

Associate Planner

City of Sammamish

801 228th Avenue SE

Sammamish, Washington 98075

Request to Rescind the “Permit Application Complete” for the Shoreline Substantial Development Trail Segment 2B-SSDP2016-00415 of the Lake Sammamish Trail is based on comments to the Sammamish City Council and our review of the 60% plans.

Ted and Elaine Davis Ted.Davis@Comcast.net

3137 East Lake Sammamish Shore Lane SE

Sammamish, WA98075

See LANDSCAPE PLAN LA3 296+50

Our Property is located on PLAN AND PROFILE AL3 adjoining marker number 296.50 and on EXISTING CONDITIONS AND PLANS EX3. We have questions regarding the open and unresolved land ownership issue and the 60% REVIEW SUBMITTAL recently published and ask the Shoreline Substantial Development Permit no. 2016-00415 be rescinded until these questions are addressed and answered.

Comments to the Sammamish City Council Meeting on January 10, 2017

In the process of coming to decisions, on issues before you, much of the research and investigation is not performed by you individually, but by staff, consultants and other types of contractors working for the city.

That is why I believe, regarding the decision on December 13 that deemed the Sammamish “Trail Application Complete” you may not have all the information needed/required to make that decision regarding Corridor Parcel 292506-9007 of the East Lake Sammamish Trail Segment 2B.

If you have lived in your home for over 18 years the same structure prior owners lived in since 1968 and you recently discovered your house had a ROW line drawn, on the proposed 60% trail parcel maps, through the front entry of your home, through the upstairs bedroom walk in

**Exhibit 29
SSDP2016-00415
004733**

closet and through most your carport.... **you would be concerned**, and I believe you would want to resolve the issue. **(See Images # 1 and # 2)**

This is especially important to us when the City Attorney's letter dated 14 December, 2016, references comments such as: "That real property included within the legal description of for the Corridor Parcel is under King County Control and use," "Free and clear of all claims by the Plaintiffs." This opinion also indicates that King County "is entitled to the exclusive use and possession of the area on, above, and below the surface for railroad purposes and incidental uses permitted under Washington law".

I believe you would agree, if you were us, you would want clarification as prescribed under SMC 20.05.040 *Application Requirements (1) (r) Verification of that property is in the exclusive ownership of the applicant.*

I mentioned earlier you may not have had all the information needed to make your decision. The information you are missing *is* Several Lake Sammamish home owners have ongoing litigation with King County, challenging the original ownership of portions of the ROW and the width of the easement used by the railroad. That was not mentioned, perhaps his office did not know, in the letter from the City Attorney to the City Council. The case is 15-2-20483-1 SEA

We are not part of the Pechman case or that litigation. Our purpose before you today is to request the Sammamish City Council rescind the Permit Application Complete until the litigation at the state court level, regarding who has clear title to the land in the "Corridor" has been resolved or we meet with representatives of King County to solve the land ownership and easement issues for the good of all.

Comments regarding questions to be answered in the 60% plans

We have reviewed the 60% plans and see in several areas close to us, the needs of the trail have been balanced while trying to minimizing the impact on the adjoining property owners.

1 Will the Concrete block wall remain after the trail construction has been completed?

As we review the CG (Clearing and Grading) we cannot determine if the concrete block wall plans simply have not been addressed, if there was an omission of the plans or what is the planned future for the wall. The concrete block wall is between 12 and 14 feet from the trail center line. The CG touches and splits a portion of the concrete block wall, but not the entire wall. The single vehicle lane where our house is located, is inside the ROW and has one way in and the same way out. The lane provides very limited parking for residents, delivery trucks, maintenance personnel and guests. Daily, our neighbors and our family use the area between the asphalt lane in front of our houses and the concrete block wall for parking. Most importantly, this area provides a wide spot on the lane for emergency vehicles and regularly

Exhibit 29
SSDP2016-00415
004734

aids other vehicles in turning around instead of having to back all the way up the lane.
(See image # 3 Wall)

2 Will the CG (Clearing and Grading) remove the cedar fence and the plants that are currently between the concrete wall and the gravel trail during construction and what type of fence will replace the current fence?

Currently, as indicated on the 60% plans a permitted 6-foot tall cedar fence separates the gravel trail from the top of the wall. What is not noted on the plans is the 4-foot height from the top of the wall to the gravel parking area below. (See image # 3 Wall)

3 Will parking, continue along the concrete block wall, by marker 296.50 during construction?

Parking spaces along our lane are scarce under normal conditions. Any reduction in available parking will be burden on the home owners and or anyone wanting to park in along the lane. How does the King County plan to accommodate parking along East Lake Sammamish Shore Lane SE during the construction?

5. Stairs/steps (#5 at marker 296.60?) to the trail are shown, on the 60% plans as existing. How will the county accommodate a gate to the trail, currently accessed by stairs (#5 at marker 296.60)? Part of the stairs (#5) are outside of the ROW how will they be incorporated into the final plan? (See Image #4 Steps)

6. We do not see there are no plans for replacement steps on the east side of the trail close to marker 295.20 that lead to East Lake Sammamish Parkway SE. Was this an omission or simply the plans for steps have not been completed?

The current steps are used daily by residents on the entire lane homeowners to access their mailboxes and areas along the East Lake Sammamish SE Parkway for parking. If the steps are not replaced individuals must walk approximately ½ mile round trip on East Lake Sammamish Shore Lane SE and along a dangerous curved section of the Parkway to access their mail and overflow parking. At least 4 home owners are retired and the absence of a stairway for access to their mailboxes and parking will be burden to them. What can the county do to address this issue and accommodate these concerns? (See image # 5)

7 During construction how does the county plan to replace our access to the mailboxes and the parking areas, currently accessed by the stairs, along East Lake Sammamish Parkway SE?

Until these concerns, along with the land ownership issues, are addressed the City of Sammamish will not have enough information on which to determine if the application is complete and should not move forward with their final decision on the permit.

Images referenced above on next page

Image # 1 Photo of homes with ROW imposed;



Image #2 Davis home (3137) with ROW marker next to north side of home.



Image # 3 Concrete Block Wall with 6 ft. Cedar Fence



Image # 4 Steps to Trail



Image # 5 Steps from Trail to East Lake Sammamish Parkway SE



End of Images/End of Comments

Respectfully submitted,

Ted & Elaine Davis